

Coupler

Ace Coupler

Compact Ace Coupler

Auto Ace Coupler

Korea Type Coupler

Minor Coupler

HP Coupler

Mold Coupler

Cam-Lock Coupler

COMPACT ACE COUPLER

용도

- 압축공기의 배관 연결시에 사용합니다.
- Air공구(드라이브, 임팩트 등)에 장착하여 사용합니다.

특징

- 홀(Hole)에 자동개폐밸브를 내장한 편로 개폐형 카플러입니다.
- 공기압 공구의 호스연결, 공장의 공기 배관용 등 폭넓게 사용이 가능합니다.

사양

사용유체	Air
재 질	Steel(chrome~plated)
사용압력	10Kgf/cm ² (1000kPa)
최대사용압력	20Kgf/cm ² (2000kPa)



구조도

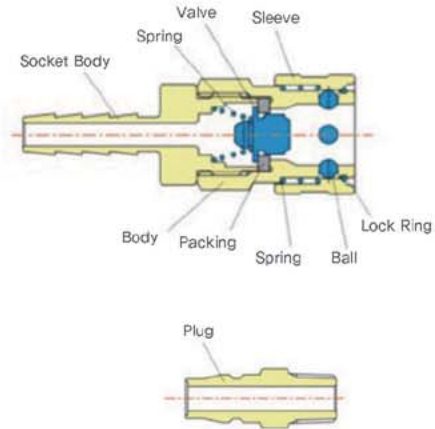

주문형식

H S H 22

① ② ③ ④

① 품명

H : Socket

② 몸체 크기 : Small

③ 형식

H	Hose Stem
M	Male Thread
F	Female Thread
N	Hose Nut Type

④ 나사의 크기

Size	22	23	24
H	9	11	15
M	R1/4	R3/8	R1/2
F	Rc1/4	Rc3/8	Rc1/2

Size	21	23	24
N	8 X 5	10 X 6.5	12 X 8

▶ 최소단면적 (mm²)

22 Type		23 Type		24 Type	
H	M · F	H	M · F	H	M · F
19	32	32	32	32	32

HSH

Socket Nipple

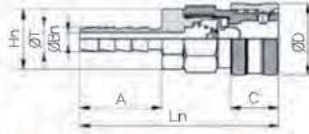

MODEL [ØD-T] Tube(Metric)-Thread(R) (mm)

CODE	MODEL	ØD	ØT	H	A	L	W.G(g)	Q'ty/ Inbox
591310001002	HSH 22	23,6	9	19	27	61,4	68,7	25
591310001003	HSH 23	23,6	11	19	29	63,4	72	25
591310001004	HSH 24	23,6	14,8	19	33	67,4	87,3	25

HSM

Socket Male

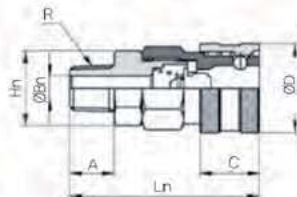

MODEL [ØD-T] Tube(Metric)-Thread(R) (mm)

CODE	MODEL	ØD	A	L	H	R	W.G(g)	Q'ty/ Inbox
591320000102	HSM 22	23,6	13,5	47,9	19	R1/4	67,8	25
591320000103	HSM 23	23,6	14	48,4	19	R3/8	71,6	25
591320000104	HSM 24	23,6	15	49,4	20,6	R1/2	82,8	25

HSF

Socket Female

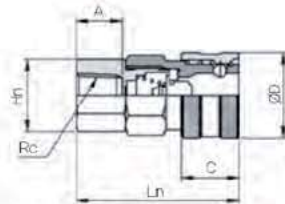

MODEL [ØD-T] Tube(Metric)-Thread(R) (mm)

CODE	MODEL	ØD	A	L	H	R	W.G(g)	Q'ty/ Inbox
591330000202	HSF 22	23,6	17,5	45,9	19	R1/4	77,8	25
591330000203	HSF 23	23,6	18,5	46,9	20,6	R3/8	77,4	25
591330000204	HSF 24	23,6	20	48,4	25	R1/2	90,3	25

HSN

Socket Nut

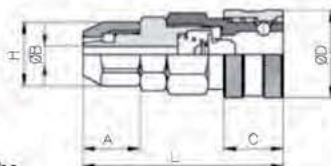

MODEL [ØD-T] Tube(Metric)-Thread(R) (mm)

CODE	MODEL	ØD	A	L	H1	H2	H×Ø	W.G(g)	Q'ty/ Inbox
591340002001	HSN 21	23,6	14	48,4	19	14	Ø8×5	70,5	25
591340002003	HSN 23	23,6	16	50,4	19	15	Ø10×6,5	73,6	25
591340002004	HSN 24	23,6	19	53,4	19	19	Ø12×8	82,4	25

HSN-S

Socket Nut-S

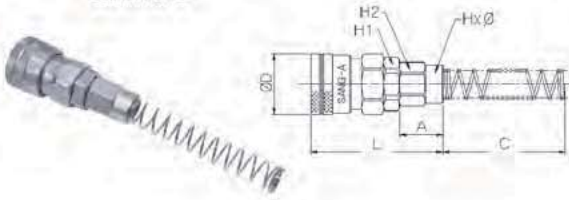

MODEL [ØD-T] Tube(Metric)-Thread(R) (mm)

CODE	MODEL	ØD	A	L	C	H1	H2	H×Ø	W,G(g)	Q'ty/ Inbox
591340002005	HSN S21	23.8	16.7	51.1	71.8	19	15	Ø8×5	79.8	25
591340002006	HSN S23	23.8	20.5	54.9	76.2	19	16	Ø10×6.5	87	20
591340002007	HSN S24	23.8	25	65	75.9	19	19	Ø12×8	97	20